

Detail is subject to SE approval

Detail Issued For Guidance Only,
Designer's Approval Required

Site construction sequencing should be assessed before the appropriate Visqueen Standard Detail is selected & approved by the Designer

Visqueen Axiom ConSeal
concrete joint filler

Visqueen Axiom Guard
Liquid Membrane (one coat grey)
on Axiom Guard Primer on
smooth float finish concrete

Expansion joint filler
by others

NB; A sacrificial DPM may be
required - seek advice from
engineer

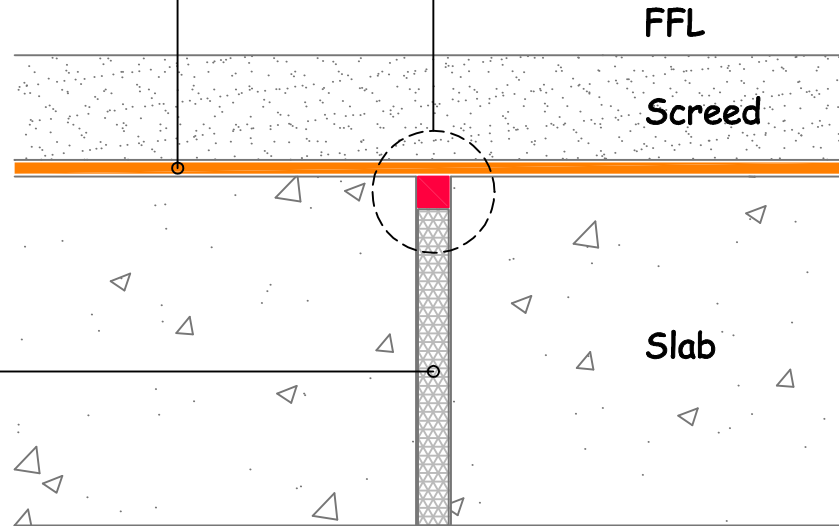

TYPICAL MOVEMENT JOINT DETAIL

NB ; DO NOT SCALE - USE FIGURED DIMENSIONS ONLY.

VISQUEEN AXIOM
LIQUID WATERPROOFING SYSTEM

Visqueen Building Products
Contact Technical Support :
t : 0333 202 6800
f : 0333 202 6886
e : enquiries@visqueenbuilding.co.uk
www.visqueenbuilding.co.uk

Project: Standard Detail : Visqueen Axiom Liquid Membranes.

© COPYRIGHT
RESERVED.

AX-31

Ground Bearing Slab

Axiom Guard

Axiom ConSeal

Liquid Membrane

In order to develop a robust design for protecting a structure against groundwater, a risk assessment must be carried out in line with the guidance given in BS8102:2009

The designer may need to specify one or a combination of waterproofing measures